

RoHS

This products can apply to the HRS Doc NO. QA-3-04-005 of Environmental&Material Management Rules

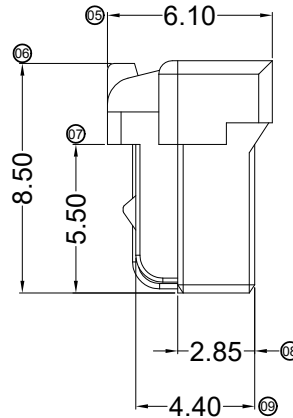

02P~03P Shape Scale 1:1

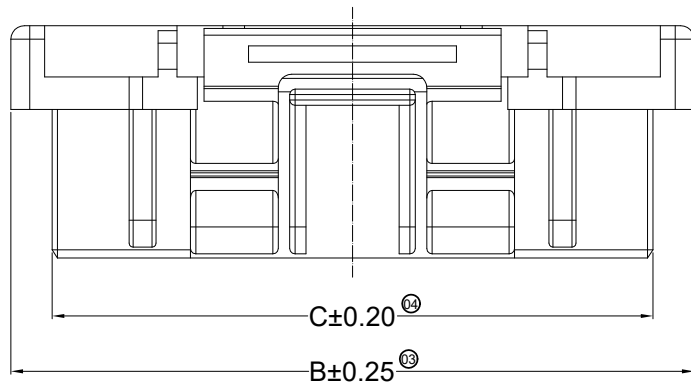
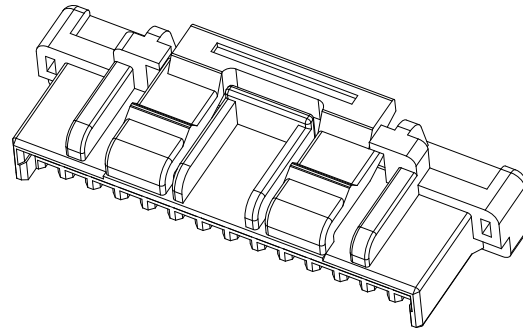
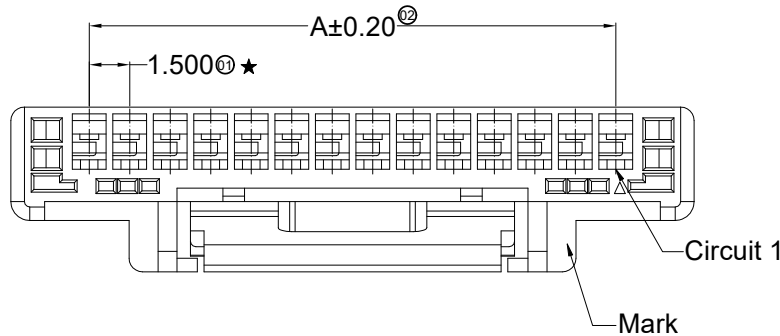
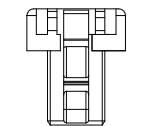
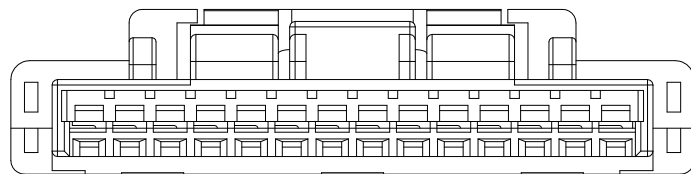

02P~03P Shape Scale 1:2

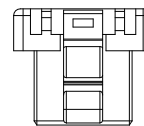

04P~05P Shape Scale 1:2

■ Specifications :

- Voltage rating: 100V AC / DC
- Current rating: 2A AC / DC
- Withstanding voltage: 500V AC/minute
- Temperature range: -40°C~+105°C
- Insulation resistance:≥500MΩ
- Contact resistance: ≤20mΩ
- After environmental testing: ≤40mΩ
- Suitable HRS Terminal:HRS-1515T
- Mates With HRS Wafer:HRS-1515W
- "★" Critical dimension

HRS-1515 H X-XX X-XX XX XX
 ① ②③ ④⑤ ⑥ ⑦ ⑧

- ① Series No.
- ② Category: H-HSG
- ③ Appearance type: Blank-ordinary
- ④ Row No.-Pin No.: XX-02P~15P
- ⑤ Special No.: Blank-Ordinary
- ⑥ Material: N0-PA66 94V-0
- ⑦ Color: Blank-Natural Color
- ⑧ HF-Halogen Free

Poles	Dimensions (mm)			Poles	Dimensions (mm)		
	A	B	C		A	B	C
02	1.50	7.30	4.25	09	12.00	17.80	14.75
03	3.00	8.80	5.75	10	13.50	19.30	16.25
04	4.50	10.30	7.25	11	15.00	20.80	17.75
05	6.00	11.80	8.75	12	16.50	22.30	19.25
06	7.50	13.30	10.25	13	18.00	23.80	20.75
07	9.00	14.80	11.75	14	19.50	25.30	22.25
08	10.50	16.30	13.25	15	21.00	26.80	23.75

							GENERAL TOLERANCE		Horus Int. Electronics Co., LTD. Horustech Electronics Co., LTD.				PART NO.			
							X	±0.30					HRS-1515H-XX-N0XX			
							.XX	±0.20	TITLE							
							.XXX	±0.10	1.50mm Crimp Style Connectors							
2019/07/10	A	B	EN20190710002	Cancel the PBT material	Hai Li	Robing	PROJECT	APPROVAL	CHECK	DRAWN	DATE	UNIT	SCALE	NUMBER	REV	
DATE	OLD REV	NEW REV	ECN	DESCRIPTION	CHECK	APPROVAL	Robing	Hai Li	Yu wei	2014/06/03	MM	1:1	A-000	B		

RoHS

This products can apply to the HRS Doc NO. QA-3-04-005 of Environmental&Material Management Rules

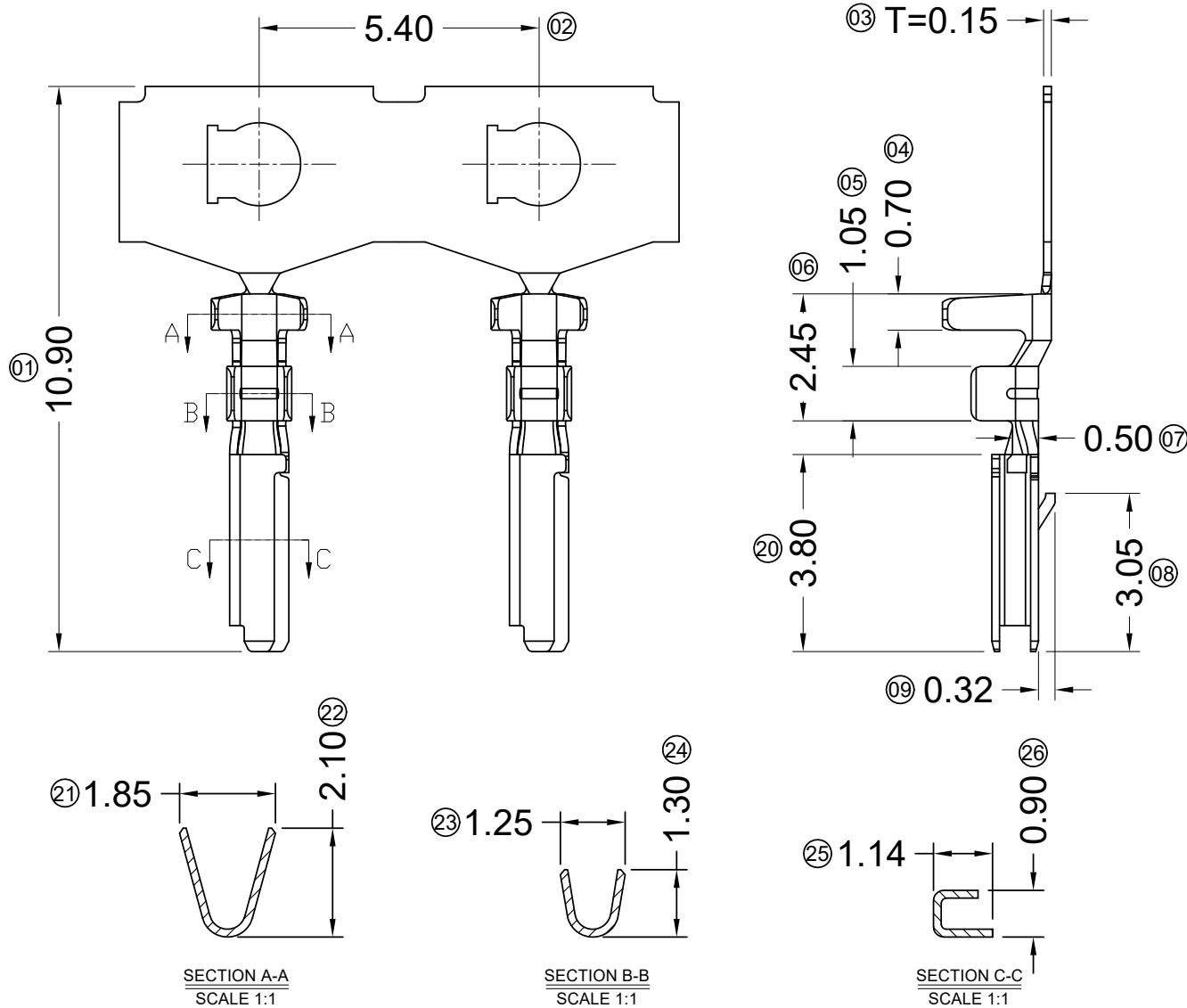

■ Specifications :

- Voltage rating: 100V AC / DC
- Current rating: 2A AC / DC
- Withstanding voltage: 500V AC/minute
- Temperature range: -40°C~+105°C
- Insulation resistance: ≥500MΩ
- Contact resistance: ≤20mΩ
- After environmental testing: ≤40mΩ
- Material(Pin): Phosphor bronze
- Mates With HRS Housing : HRS-1515H

HRS-1515 T X - P SN X - X
 ① ②③ ④ ⑤ ⑥ ⑦

- ① Series Number
- ② Category: T-terminal
- ③ Shape: Blank-ordinary
- ④ Material: P-Phosphor bronze
- ⑤ Plating code: SN-Bright tin plating
- ⑥ Plating method:
Blank-Stamping before plating
- ⑦ Mold No./Mark/Special No.

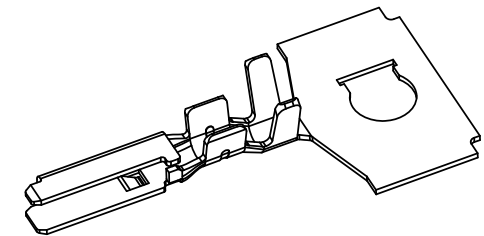

						GENERAL TOLERANCE .X ±0.30 .XX ±0.20 .XXX ±0.10 X.° ±2°				PART NO. HRS-1515T-PSN				
						Horus Int. Electronics Co., LTD. Horustech Electronics Co., LTD.				TITLE 1.50mm Crimp Style Connectors				
2020.3.17	D	EN20200317002	Update Drawing Frame	YY'ting	Robing	APPROVAL	CHECK	DRAWN	DATE					
DATE	REV	ECN NO.	DESCRIPTION	MODIFY	APPROVAL	PROJECT				UNIT	SCALE	SHEET	REV	NUMBER
						Robing	YY'ting	Wuxiaotao	2018/06/05	mm	1:1	1/1	D	A-014

RoHS

This products can apply to the HRS Doc NO. QA-3-04-005 of Environmental&Material Management Rules

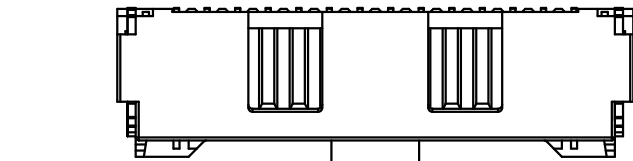

06P-15P Single Hole

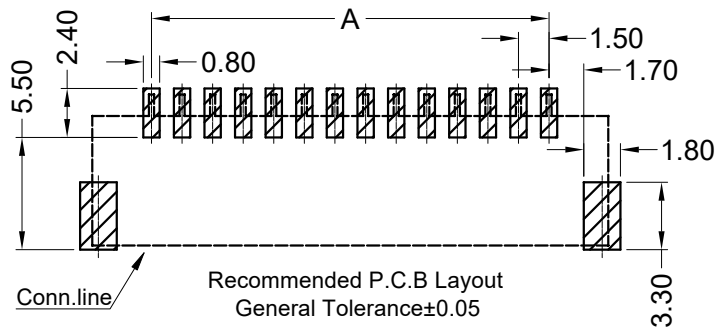
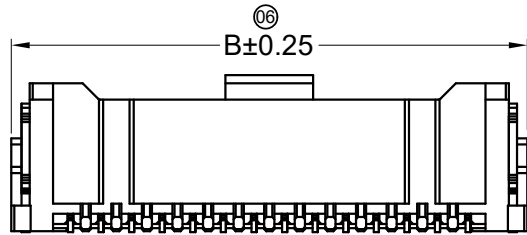
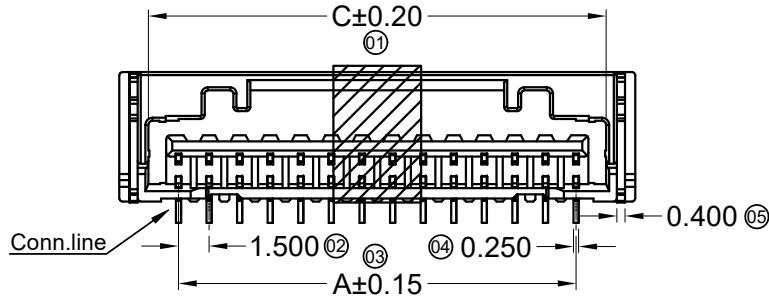

Recommended P.C.B Layout
General Tolerance±0.05

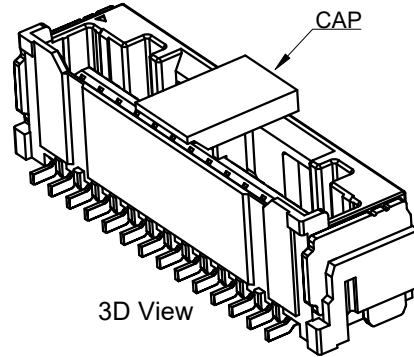

3D View

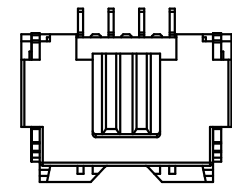
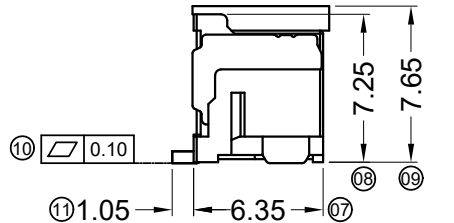

03P-05P Single Hole
Scale 1:1

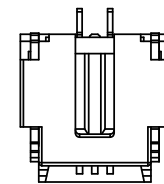

02P Single Hole
Scale 1:1

■ Specifications :

- Voltage rating: 100V AC / DC
- Current rating: 2A AC / DC
- Withstanding voltage: 500V AC/minute
- Temperature range: -40°C~+105°C
- Insulation resistance:≥500MΩ
- Contact resistance: ≤20mΩ
- After environmental testing: ≤40mΩ
- Material(Pin): Phorphos Bronze
- Material(Stator): Brass
- Mates With HRS Housing : HRS-1515H

HRS-1515 W V S - XX X - LP SW XX
① ② ③ ④ ⑤ ⑥ ⑦ ⑧ ⑨

- ① Series No.
- ② Category: W-wafer
- ③ Connector type: V- Straight 180°
- ④ Mouting type: S-SMT
- ⑤ Row No.-Pin No per row: XX-02P~15P
- ⑥ Special No.:
- ⑦ Material: LP -LCP 94V-0 ;
- ⑧ Plating Code: SW- Matte Tin Plating
- ⑨ Color: Blank-Natural Color

Poles	Dimensions (mm)			Poles	Dimensions (mm)		
	A	B	C		A	B	C
02	1.50	7.30	4.45	09	12.00	17.80	14.95
03	3.00	8.80	5.95	10	13.50	19.30	16.45
04	4.50	10.30	7.45	11	15.00	20.80	17.95
05	6.00	11.80	8.95	12	16.50	22.30	19.45
06	7.50	13.30	10.45	13	18.00	23.80	20.95
07	9.00	14.80	11.95	14	19.50	25.30	22.45
08	10.50	16.30	13.45	15	21.00	26.80	23.95

DATE	REV	ECN NO.	DESCRIPTION	MODIFY	APPROVAL	PROJECT	APPROVAL	CHECK	DRAWN	DATE	UNIT	SCALE	SHEET	REV	NUMBER
2021.01.30	J	EN20210130001	Increase The Series Sketch Map	YY'ting	Robing	PROJECT	Robing	YY'ting	YY'ting	2020.3.12	mm	1:1	1/2	J	A-000
2020.03.12	H	EN20200317002	Update Drawing Frame	YY'ting	Robing	PROJECT	Robing	YY'ting	YY'ting	2020.3.12	mm	1:1	1/2	J	A-000

Horus Int. Electronics. Co., LTD.
Horus Int. Electronics. Co., LTD.

PART NO.
HRS-1515WVS-XX-LPSW

TITLE 1.50mm Crimp Style Connectors

RoHS

This products can apply to the HRS Doc NO. QA-3-04-005 of Environmental&Material Management Rules

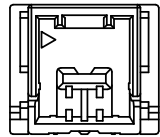

2 PIN

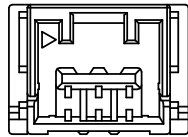

3 PIN

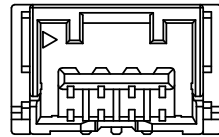

4 PIN

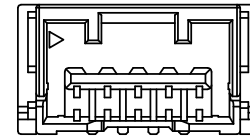

5 PIN

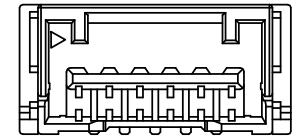

6 PIN

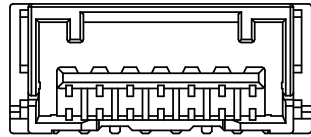

7 PIN

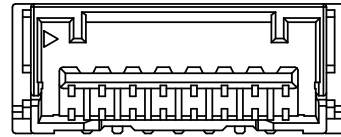

8 PIN

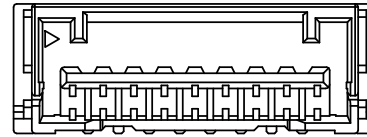

9 PIN

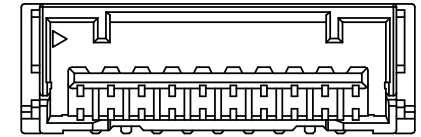

10 PIN

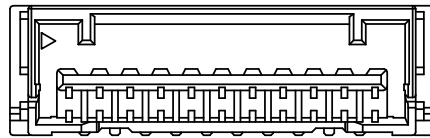

11 PIN

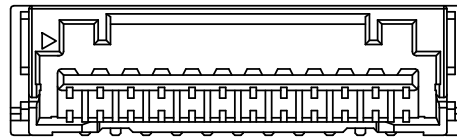

12 PIN

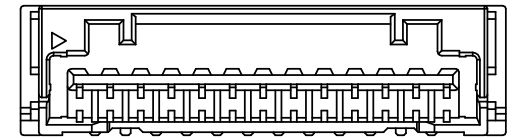

13 PIN

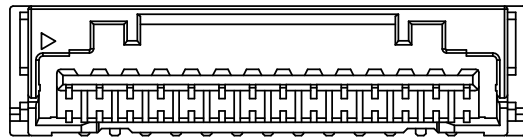

14 PIN

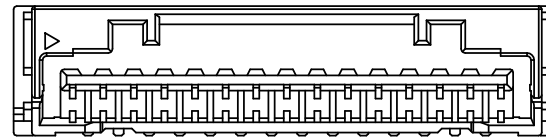

15 PIN

						<p>GENERAL TOLERANCE</p> <p>.X ±0.30</p> <p>.XX ±0.20</p> <p>.XXX ±0.10</p> <p>X.° ±2°</p>				<p>Horus Int. Electronics. Co., LTD.</p> <p>Horustech Electronics. Co., LTD.</p>					<p>PART NO. HRS-1515WVS-XX-LPSW</p>				
2021.01.30	J	EN20210130001	Increase The Series Sketch Map	YYting	Robing	APPROVAL				CHECK	DRAWN	DATE	TITLE 1.50mm Crimp Style Connectors						
2020.03.12	H	EN20200317002	Update Drawing Frame	YYting	Robing	Robing	YYting	YYting	2020.3.12	UNIT	SCALE	SHEET	REV	NUMBER					
DATE	REV	ECN NO.	DESCRIPTION	MODIFY	APPROVAL	PROJECT				mm	1:1	2/2	J	A-000					

RoHS

This products can apply to the HRS Doc NO. QA-3-04-005 of Environmental&Material Management Rules

■ Specifications :

- Voltage rating: 100V AC / DC
- Current rating: 2A AC / DC
- Withstanding voltage: 500V AC/minute
- Temperature range: -40°C~+105°C
- Insulation resistance:≥500MΩ
- Contact resistance: ≤20mΩ
- After environmental testing: ≤40mΩ
- Material(Pin): Phorphos Bronze
- Material(Stator): Brass
- Mates With HRS Housing:HRS-1515H-XX

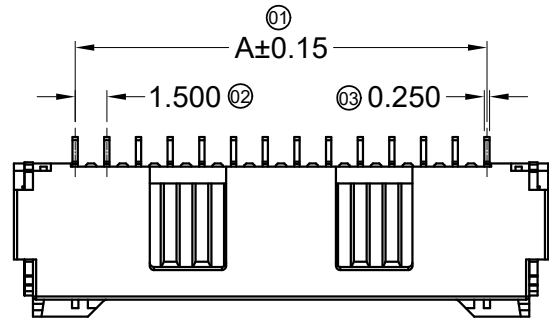

06P-15P Double Hole
Scale 1:1

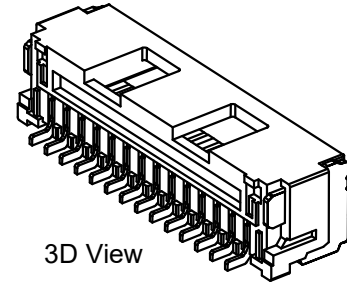

3D View

HRS-1515 W R S - XX X - XX SW XX
① ②③④ ⑤ ⑥ ⑦ ⑧ ⑨

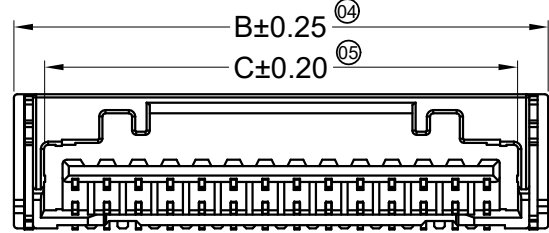

Circuit 1

⑥ 0.400

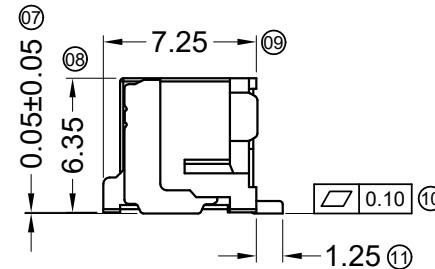

- ① Series No.
- ② Category: W-wafer
- ③ Connector type: R- Right angle 90°
- ④ Mouting type: S-SMT
- ⑤ Row No.-Pin No per row: XX-02P~15P
- ⑥ Special No.:
- ⑦ Material: LP -LCP 94V-0 ;9T-PA9T 94V-0
- ⑧ Planting Code: SW- Matte Tin Plating
- ⑨ Color: Blank-Natural Color;BK-Black

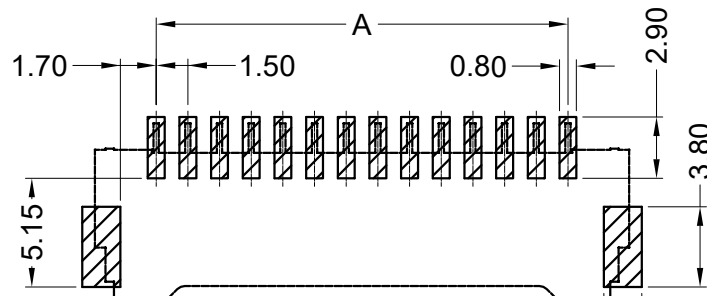

Conn.line

Recommended P.C.B Layout
General Tolerance±0.05

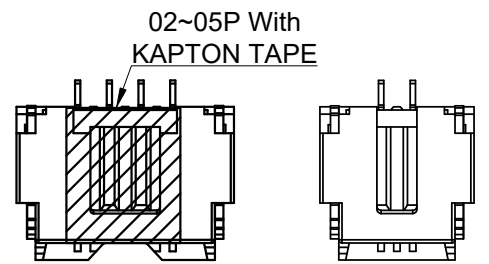

03P-05P Single Hole
Scale 1:1

02P Single Hole
Scale 1:1

Poles	Dimensions (mm)			Poles	Dimensions (mm)		
	A	B	C		A	B	C
02	1.50	7.30	4.45	09	12.00	17.80	14.95
03	3.00	8.80	5.95	10	13.50	19.30	16.45
04	4.50	10.30	7.45	11	15.00	20.80	17.95
05	6.00	11.80	8.95	12	16.50	22.30	19.45
06	7.50	13.30	10.45	13	18.00	23.80	20.95
07	9.00	14.80	11.95	14	19.50	25.30	22.45
08	10.50	16.30	13.45	15	21.00	26.80	23.95

GENERAL TOLERANCE						APPROVAL				PART NO.					
DATE	REV	ECN NO.	DESCRIPTION	MODIFY	APPROVAL	PROJECT	Robing	YYting	YYting	DATE	HRS-1515WRS-XX-XXSWXX				
2021.01.30	J	EN20210130001	Increase The Series Sketch Map	YYting	Robing	PROJECT	Robing	YYting	YYting	2020.3.12	TITLE 1.50mm Crimp Style Connectors				
2020.03.12	H	EN20180927002	Update Drawing Frame, The Same ECR And ECN NO.	YYting	Robing						UNIT SCALE SHEET REV NUMBER				
											mm	1:1	1/2	J	A-000

Horus Int. Electronics. Co., LTD.
Horus Int. Electronics. Co., LTD.

APPROVAL CHECK DRAWN DATE

PART NO. HRS-1515WRS-XX-XXSWXX				
TITLE 1.50mm Crimp Style Connectors				
UNIT	SCALE	SHEET	REV	NUMBER
mm	1:1	1/2	J	A-000

RoHS

This products can apply to the HRS Doc NO. QA-3-04-005 of Environmental&Material Management Rules

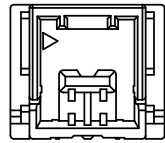

2 PIN

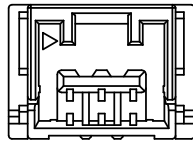

3 PIN

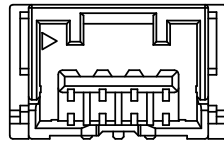

4 PIN

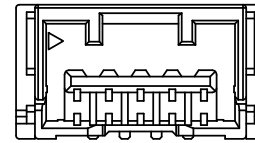

5 PIN

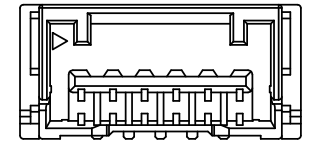

6 PIN

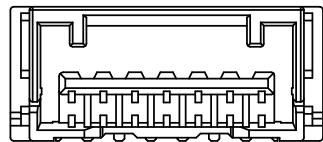

7 PIN

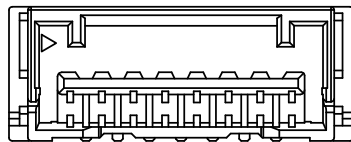

8 PIN

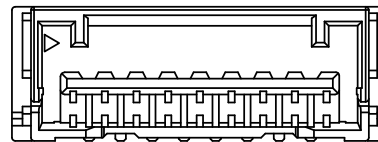

9 PIN

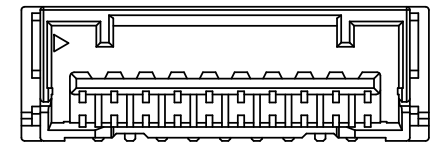

10 PIN

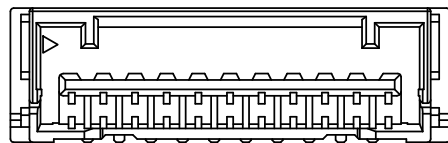

11 PIN

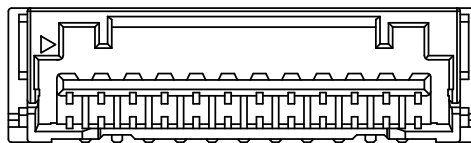

12 PIN

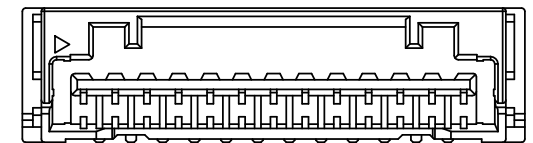

13 PIN

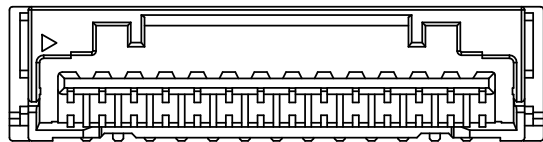

14 PIN

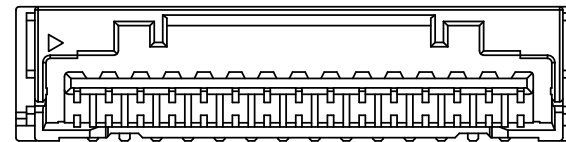

15 PIN

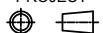
					GENERAL TOLERANCE .X ±0.30 .XX ±0.20 .XXX ±0.10 X.° ±2°		 Horus Int. Electronics Co., LTD. Horustech Electronics Co., LTD.				PART NO. HRS-1515WRS-XX-XXSWXX					
2021.01.30	J	EN20210130001	Increase The Series Sketch Map	YYting	Robing	APPROVAL					CHECK	DRAWN	DATE	TITLE 1.50mm Crimp Style Connectors		
2020.03.12	H	EN20180927002	Update Drawing Frame, The Same ECR And ECN NO.	YYting	Robing	PROJECT		Robing YYting YYting		2020.3.12		UNIT	SCALE	SHEET	REV	NUMBER
DATE	REV	ECN NO.	DESCRIPTION	MODIFY	APPROVAL							mm	1:1	2/2	J	A-000